

# HOW TO MEASURE

# D.I.Y

## Tiling Fact Sheet



The most important thing about tiling is take your time. It can be very rewarding if you take the time, relax and don't rush.

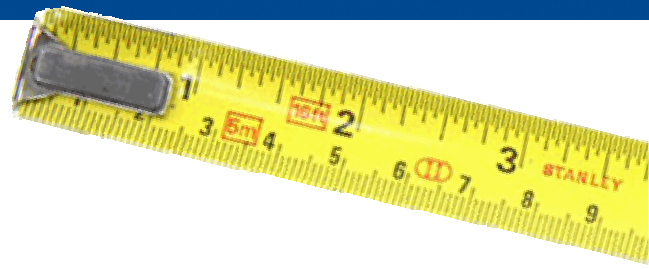

### Measure the area:

Firstly, work out how big your space is. Measure your floor then wall space. Convert meters and centimetre measurements into square meters (see below). This will assist when ordering your tiles. Next, remove all non-fixed objects from the room.

### How to get a square meter total:

**Floor:** width x depth = M<sup>2</sup>

**Wall:** length x width = M<sup>2</sup>

Add floor total to the wall total & subtract any fixed objects. To measure objects such as baths, repeat the process as above. Just to be sure to always measure twice.

### Example wall measurement

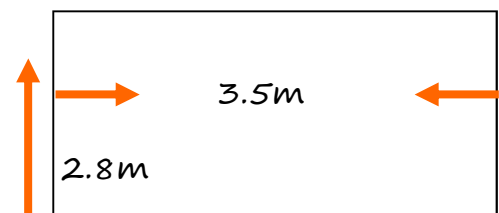

### Example floor measurement

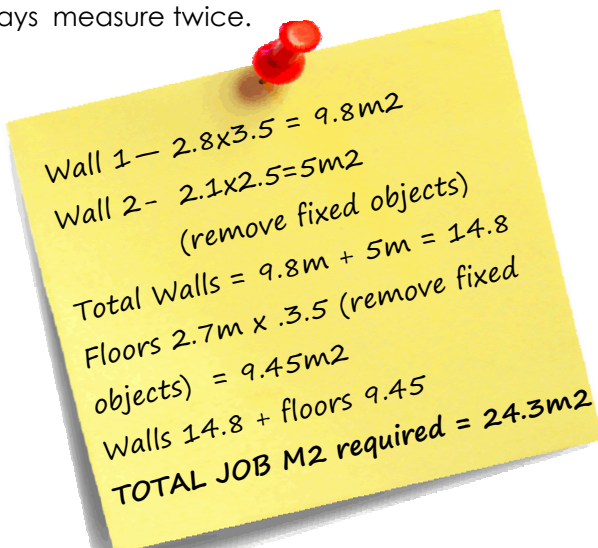
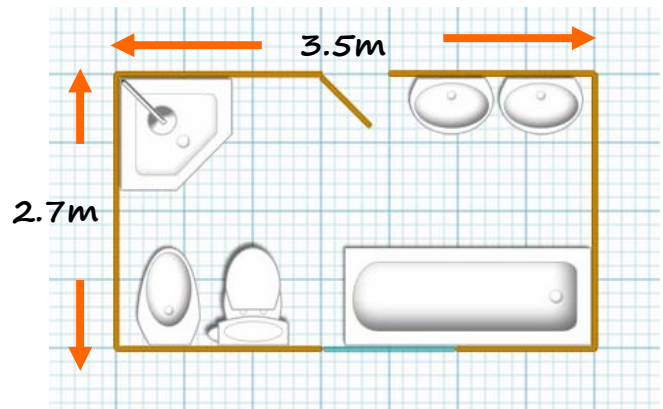

National Tiles offers a free, no obligation in home colour consultation and quotation service.

### National Tiles Tips:

- Measure around all walls and then measure the height. If the walls aren't straight, go for longest line.
- Add 10% extra when ordering your tiles for off cuts and wastage.
- Depending on the size of the tile, order between 1-3 extra boxes as you may need them in the future. Tile shades will always vary between batches, if you need to extend or replace any tiles you will have some of the same batch type ready to go.

Disclaimer: The information contained in this fact sheet is general information only. If you need further advice, you should seek professional advice based on your own circumstances.